

DC/DC Transformer

- RoHS Compliant
- Operating Temperature -40°C to +125°C
- Storage Temperature -40°C to +85°C
- $V_{t_{min}} > 9.1V_{us}$

Electrical Specifications @25°C	
Inductance:	PIN 1-3 = 475uH Min. @100KHz/0.1V
D.C.R:	PIN 1-3 = 0.31 ohm Max.
	PIN 6-4 = 0.33 ohm Max.
Turn Ratio:	PIN 6-4 : PIN 1-3 = 1.10±3% : 1
Hi-POT :	PRI. – SEC. = 3000VDC/1S/1mA

Dimensions

(Units: $\frac{\text{Inches}}{\text{mm}}$, Unless otherwise specified, all tolerances are $\pm \frac{.010}{0.25}$)

Schematic

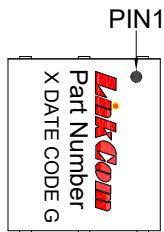

TOP VIEW

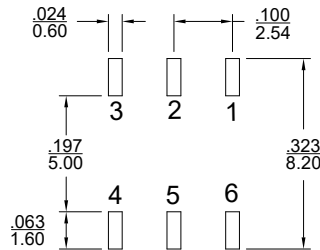

SUGGESTED PAD LAYOUT

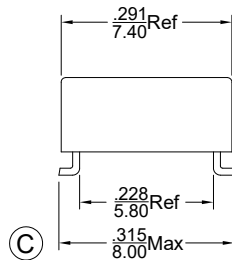
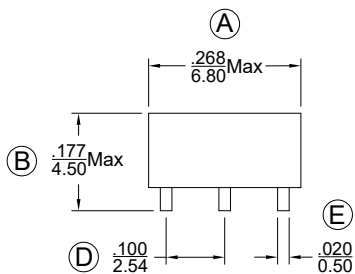
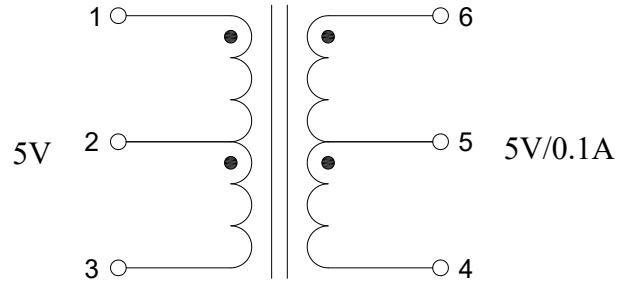

Mark

- 1.Part Number----LTC0319
2. X----PRODUCT LINE or BLANK
3. DATE CODE----YYWW
- 4.SS----50 or BLANK
5. G----RoHS

Package info

LTC0319-50R - Tape reel