

Common Mode Filter

- RoHS Compliant
- Operating Temperature -40°C to +85°C

Electrical Specifications @25°C

Inductance:	PIN 1-4= 4.7mH +50%/-30% @ 10KHz/0.1V
	PIN 2-3= 4.7mH +50%/-30% @ 10KHz/0.1V
D.C.R.:	PIN 1-4 = 900 mohm Max.
	PIN 2-3 = 900 mohm Max.
Hi-POT:	PRI. – SEC. =750VAC/2Seconds/1mA
Turn Ratio:	PIN1-4 : PIN 2-3= 1±2% :1

Dimensions

(Units: $\frac{\text{Inches}}{\text{mm}}$, Unless otherwise specified, all tolerances are $\pm\frac{.010}{0.25}$)

Schematic

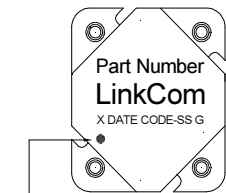

PIN1
TOP VIEW

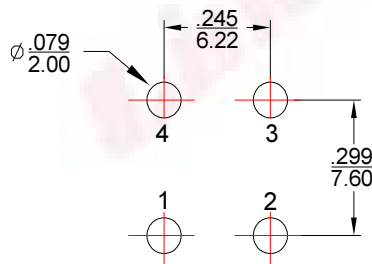

SUGGESTED PAD LAYOUT

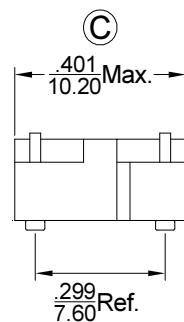
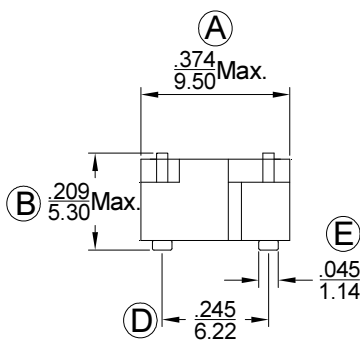
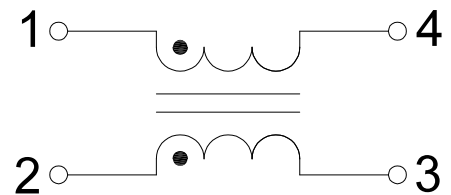

Mark

1. Part Number----LTC0060
2. X----PRODUCT LINE or BLANK
3. DATE CODE----YYWW
4. SS----52 OR BLANK
5. G----RoHS

Package info

LTC0060-52R—Tape Reel