

Toroidal Coil

- RoHS Compliant
- Operating Temperature -40°C to +85°C

Electrical Specifications @25°C	
Inductance:	PIN 1-2= 1.4 mH Min. @ 100KHz/0.1V
Leakage Inductance:	PIN 1-2= 800 nH Max. @ 100KHz/0.1V (PIN 8,5 Shorted)
Intertwining Capacitance:	PIN 1-8= 30 pF Max. @ 100KHz/0.1V
D.C.R.:	PIN 1-2 = 420 mohm Max.
	PIN 8-5 = 550 mohm Max.
Turn Ratio:	PIN 8-5 : PIN1-2 = 1.3±3% :1
Hi-POT:	PRI. – SEC. =5000 VAC/60 Hz/60 Seconds/1 mA

Dimensions

Schematic

(Units: $\frac{\text{Inches}}{\text{mm}}$, Unless otherwise specified, all tolerances are $\pm\frac{.010}{0.25}$)

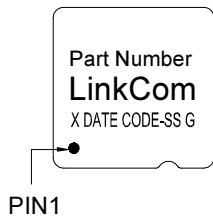

TOP VIEW

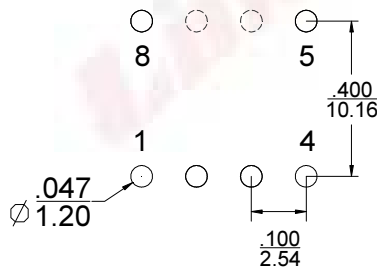

SUGGESTED PAD LAYOUT
Pin 6,7 cut off

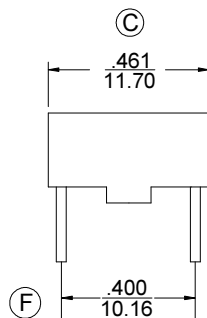
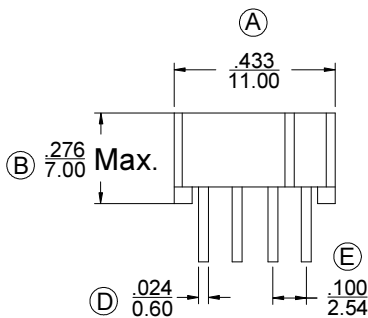
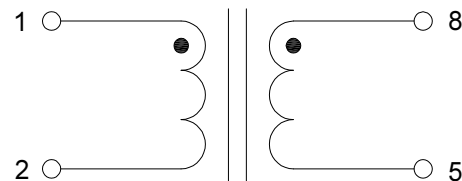

Mark

1. Part Number---LTC0526
2. X---PRODUCT LINE OR BLANK
3. DATE CODE----YYWW
4. SS----51
5. G---RoHS