



Common Mode Filters – HD1095 Series

- RoHS Compliant
- Operating Temperature -40°C to +85°C

Electrical Specifications @25°C

Inductance (mH, ±40%)	Leakage Inductance (nH, Typ.)	D.C.R. (mΩ, Max.)	Rated Current (mA)	Hi-POT (VAC/2s)	LinkCom Part Number	Height Dimension B (mm, max.)	Winding Type
0.025	920	30	2500	1000	LTC0678-50	5.85	Sectional
0.120	860	25	2500	1000	LTC0679-50	5.85	Sectional
0.220	1300	32	2200	1000	LTC0681-50	5.85	Sectional
0.250	1500	35	2000	1000	LTC0536-50	5.85	Sectional
0.470	3000	65	1600	1000	LTC0680-50	5.85	Sectional
1.000	5900	180	950	1000	LTC0535-52	5.85	Sectional
2.200	130	300	750	1000	LTC0270-50	5.85	Bifilar
3.300	130	360	650	1000	LTC0682-50	5.85	Bifilar
3.900	150	540	520	1000	LTC0683-50	5.85	Bifilar
4.700	270	720	350	1000	LTC0060-56	5.85	Bifilar
4.700	9250	250	800	500	LTC0550-51	6.20	Sectional

Dimensions

(Units: $\frac{\text{mm}}{[\text{Inch}]}$. Unless otherwise specified, all tolerances are $\pm\frac{0.25}{[.010]}$)

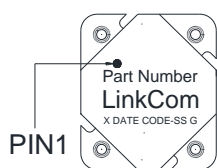

TOP VIEW

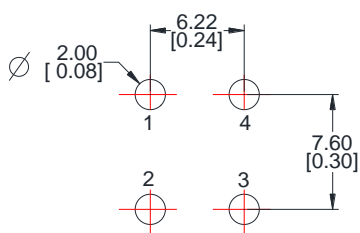

SUGGESTED PAD LAYOUT

Schematic

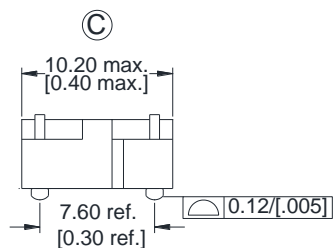
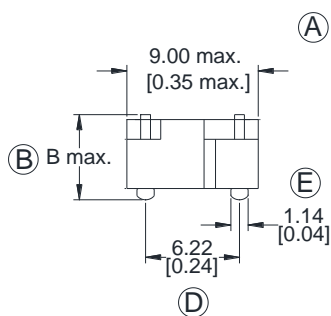
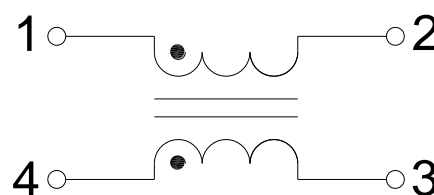



Common Mode Filters – HD1095 Series

Attenuation

— Common mode
- - - Differential mode

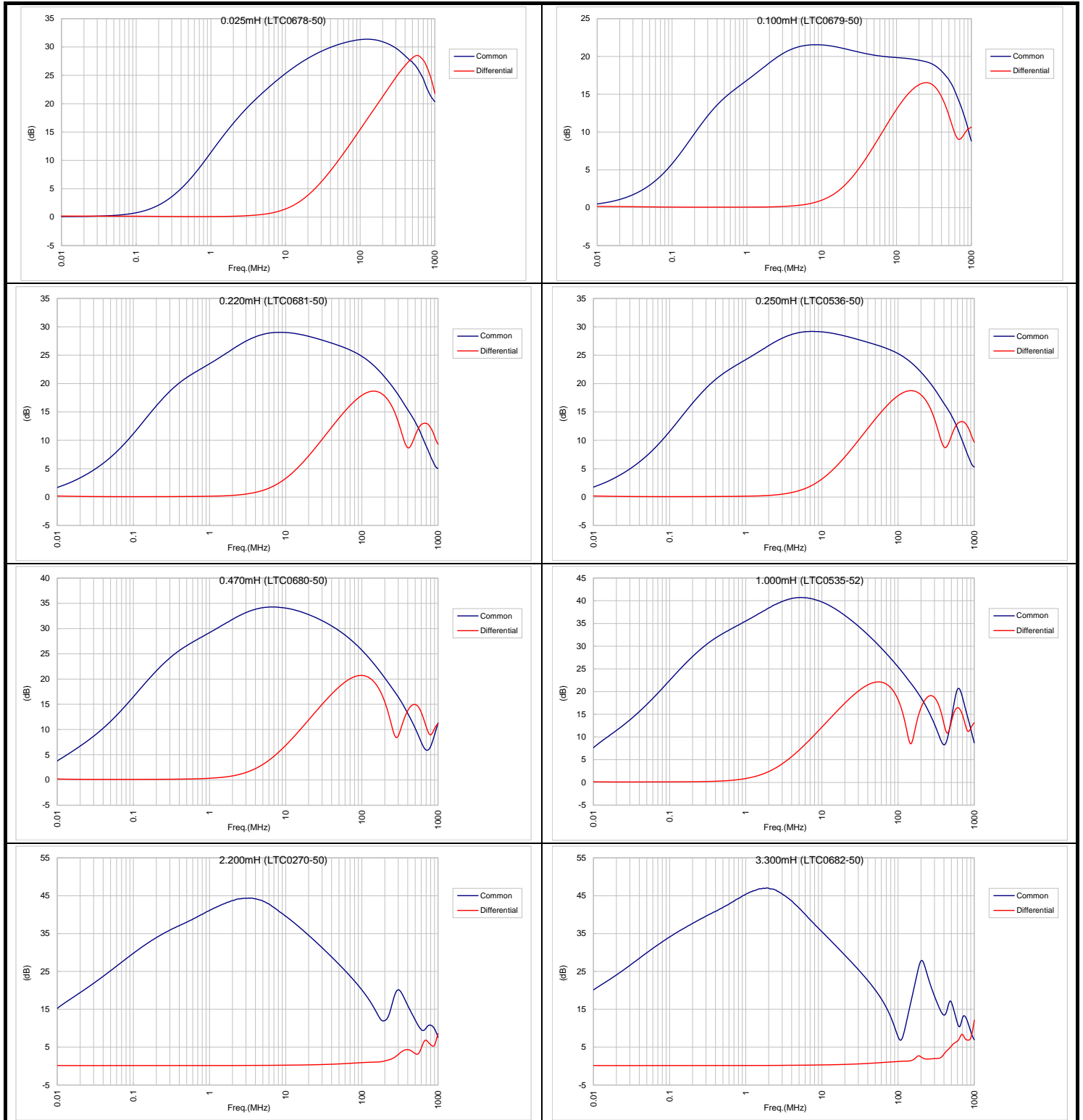



Common Mode Filters – HD1095 Series

