

Common Mode Filter

- RoHS Compliant
- Operating Temperature -40°C to +85°C
- 950mA rated current for ΔT=40 K

Electrical Specifications @25°C

Inductance	1-4 = 2-3 = 1000uH ±40%. @ 100kHz/0.1V/Series
Leakage Inductance	1-2 = 7850nH Typ. @ 1MHz/0.1V/Series (4-3 shorted)
D.C.R.	1-4 = 190 mohm Max.
	2-3 = 190 mohm Max.
Turn Ratio	1-4 : 2-3 = 1±3% :1
Hi-POT	1000VAC/2Seconds/1mA

Dimensions

(Units: $\frac{\text{Inches}}{\text{mm}}$, Unless otherwise specified, all tolerances are $\pm\frac{.010}{0.25}$)

Schematic

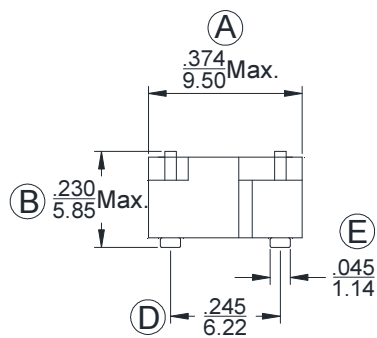
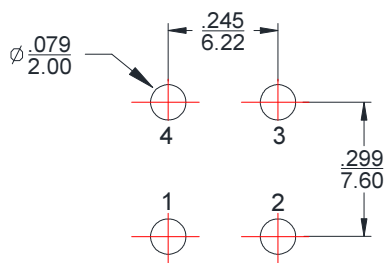
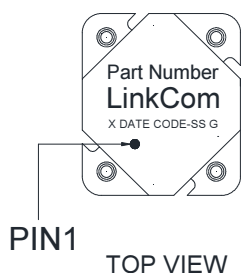
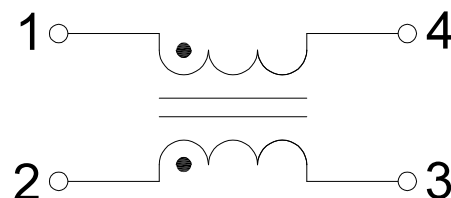

SUGGESTED PAD LAYOUT

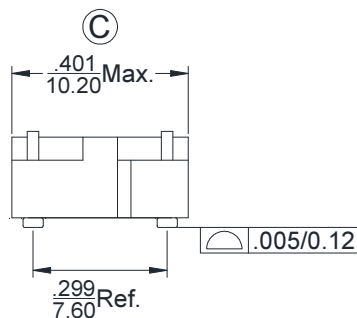

Mark

1. Part Number----LTC0535
2. X----PRODUCT LINE or BLANK
3. DATE CODE----YYWW
4. SS----50 OR BLANK
5. G----RoHS

Package info

LTC0535-50R - Reel

Typical Impedance

