

Common Mode Filter

- RoHS Compliant
- Operating Temperature -40°C to +125°C (including rated current)
- 2000mA rated current for $\Delta T=40$ K

Electrical Specifications @25°C

Inductance	1-2 = 4-3 = 250uH \pm 40%. @ 100kHz/0.1V/Series
Leakage Inductance	1-4 = 2000nH Typ. @ 1MHz/0.1V/Series (2-3 shorted)
D.C.R.	1-2 = 35 mohm Max.
	4-3 = 35 mohm Max.
Turn Ratio	1-2 : 4-3 = 1 \pm 3% :1
HI-POT	1000VAC/2Seconds/1mA

Dimensions

(Units: $\frac{\text{Inches}}{\text{mm}}$, Unless otherwise specified, all tolerances are $\pm\frac{.010}{0.25}$)



TOP VIEW

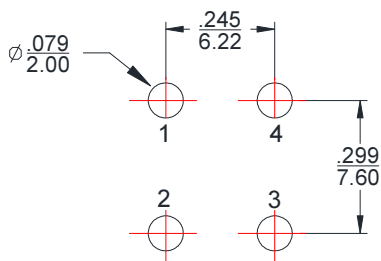

SUGGESTED PAD LAYOUT

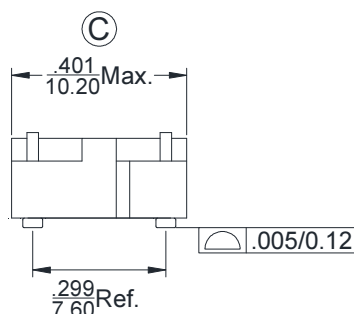
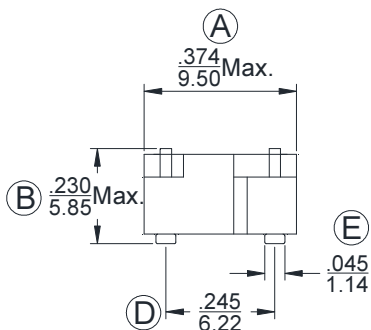

Schematic

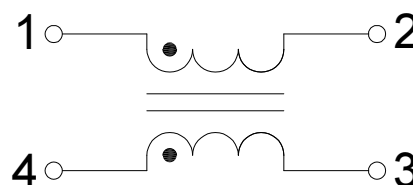

Mark

1. Part Number----LTC0536
2. X----PRODUCT LINE OR BLANK
3. DATE CODE----YYWW
4. SS----50 OR BLANK
5. G----RoHS

Package info

LTC0536-50R – Tape reel

Typical Impedance

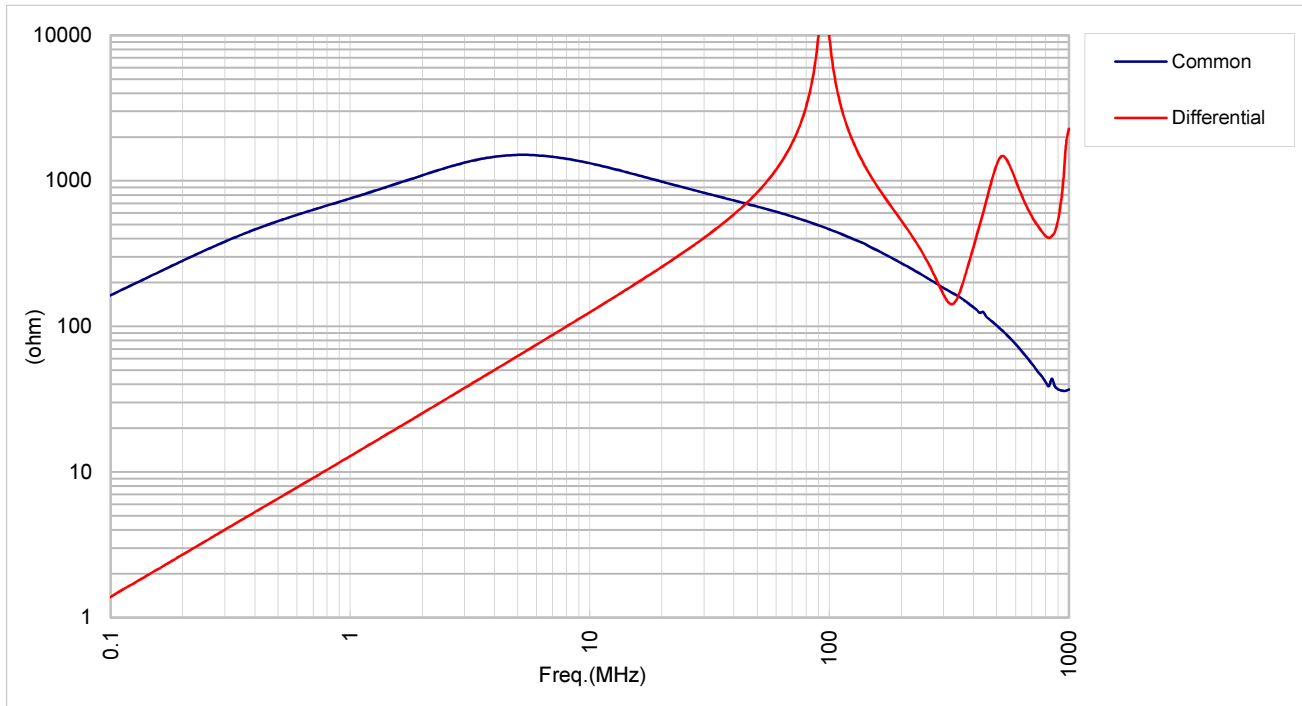

Typical Attenuation

