

RF Balun Transformer

- 75Ω Characteristic Impedance
- 1 : 1 Flux Coupled Transformer
- Frequency : 3 to 200MHz
- RF power : 250mW
- DC current : 240mA
- Operating temperature range : -40°C to +85°C
- Storage temperature range : -55°C to +100°C

Electrical Specifications @25°C, Z₀=75Ω, Pin=0dBm

Parameter	Test Conditions	Units	Typ	Max
Insertion Loss(Pin5-1)	3-5MHz	dB	1.00	2.60
	5-200MHz		0.50	0.90
Insertion Loss(Pin5-3)	3-10MHz	dB	1.00	2.60
	10-200MHz		0.40	0.75
Amplitude Balance	3-200MHz	dB	0.10	±0.30
Phase Balance	3-200MHz	Degrees	0.30	±3.00
Input Return Loss	3-5MHz	dB	13.00	-
	5-120MHz		27.00	-
	120-200MHz		21.00	-
Impedance Ratio	-	Ratio	1 : 1	-

Dimensions

(Units: $\frac{\text{mm}}{\text{Inches}}$, Unless otherwise specified, all tolerances are $\pm\frac{0.25}{.010}$)

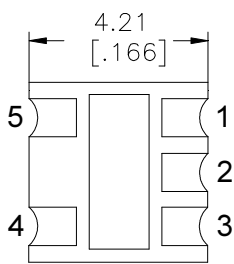

TOP VIEW

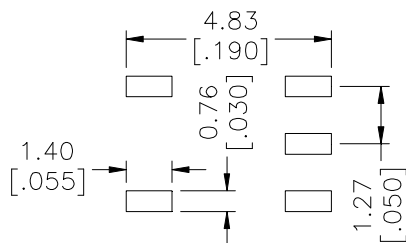

SUGGESTED PAD LAYOUT

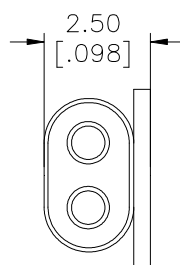
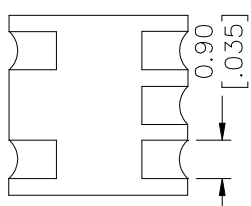

Schematic

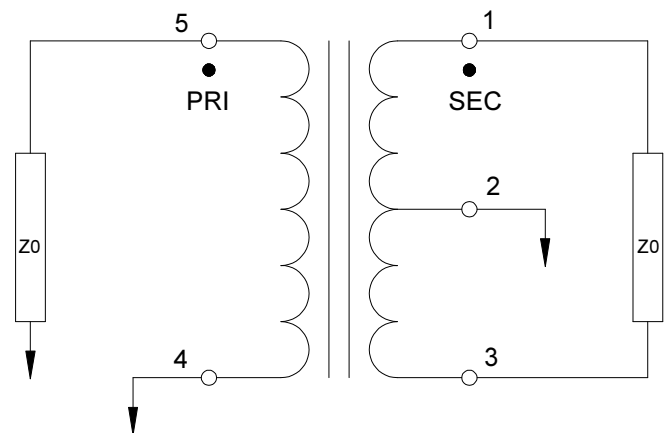

Pin configuration

Pin no.	Function
1	Secondary Dot
2	Secondary Centre Tap
3	Secondary
4	Primary
5	Primary Dot

Package info

LRT1201-50R—Tape Reel

Insertion Loss (Pin5 to 1)

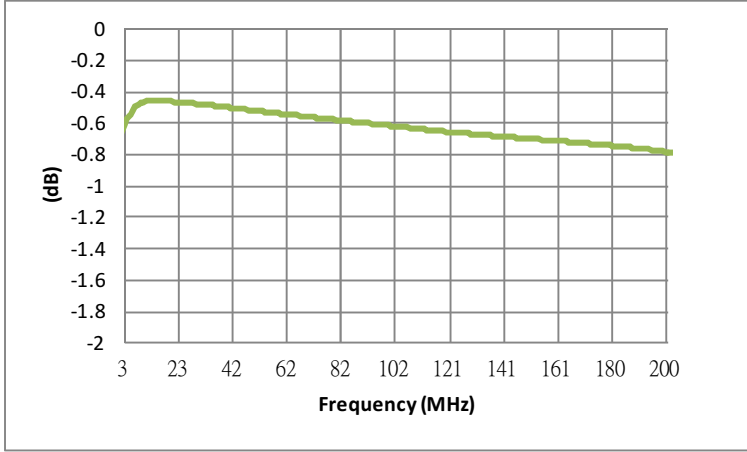

Insertion Loss 2(Pin5 to 3)

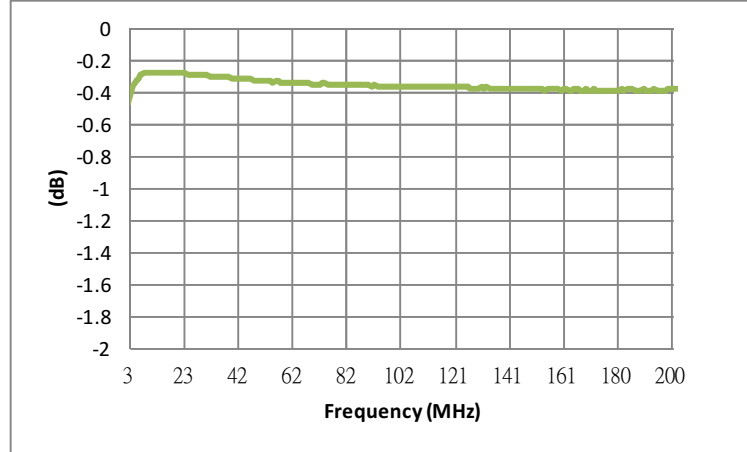

Amplitude Balance

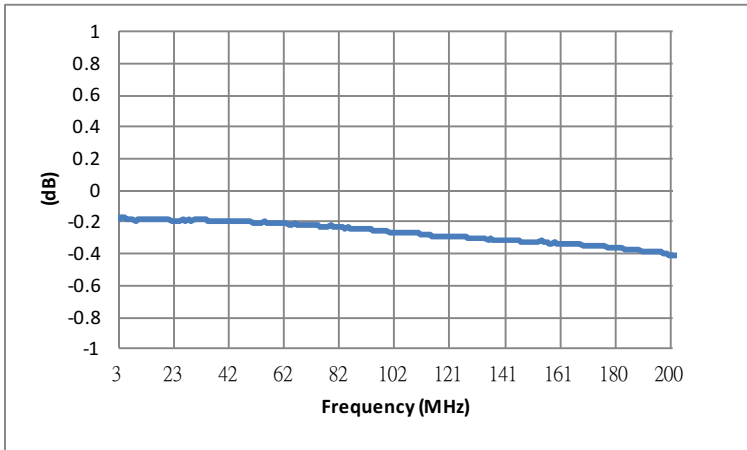

Phase Balance

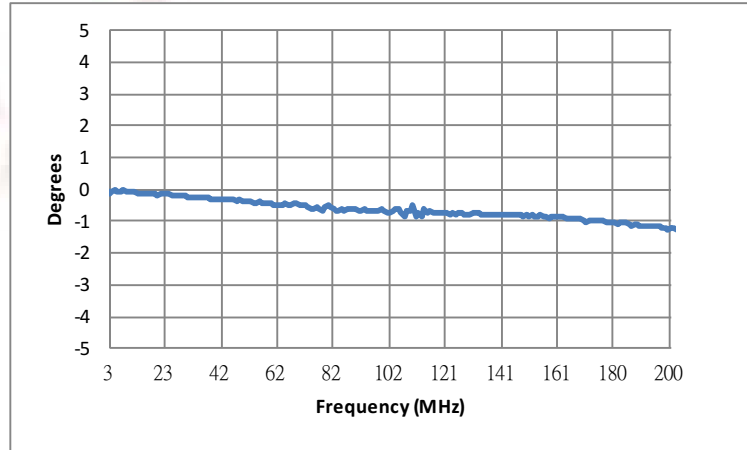

Return Loss : Input (Pin5)

