

RF Balun Transformer

- 75Ω Characteristic Impedance
- 2 : 1 Flux Coupled Transformer
- Frequency : 5 to 204MHz
- RF power : 250mW
- DC current : 200mA
- Operating temperature range : -40°C to +125°C
- Storage temperature range : -55°C to +125°C

Electrical Specifications @25°C, Z₀=75Ω, Pin=0dBm

Parameter	Test Conditions	Units	Typ	Max
Insertion Loss	5-204MHz	dB	1.40	2.00
Return Loss	5-204MHz	dB	15.00	-
CMRR	5-204MHz	-	38.00	-
Amplitude Balance	5-204MHz	dB	0.60	±1.00
Phase Balance	5-204MHz	Degrees	2.00	±5.00
Impedance Ratio	-	Ratio	1 : 2	-

Dimensions

(Units: $\frac{\text{mm}}{\text{Inches}}$, Unless otherwise specified, all tolerances are $\pm\frac{0.25}{.010}$)

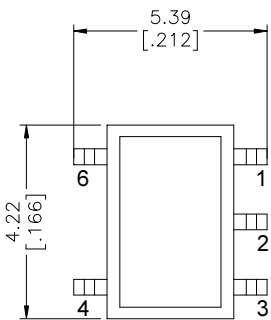

TOP VIEW

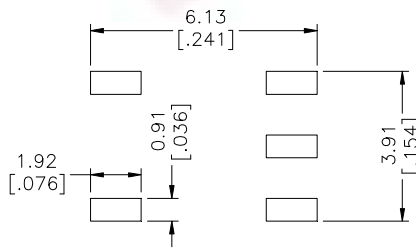

SUGGESTED PAD LAYOUT

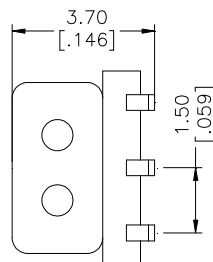
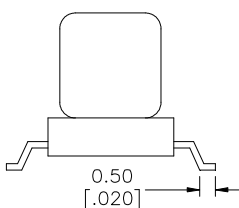

Schematic

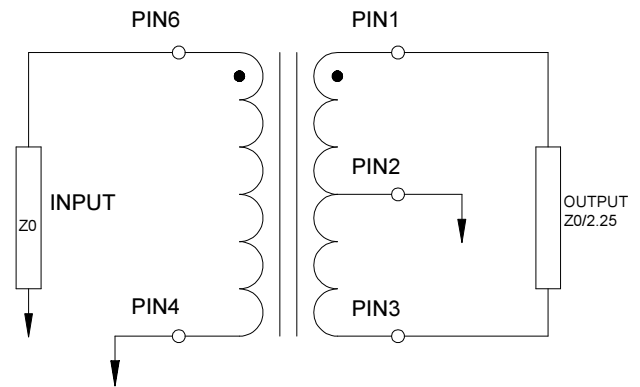

Pin configuration

Pin no.	Function
1	Secondary Dot
2	Center Tap
3	Secondary
4	Primary
6	Primary Dot

Package info

LRT1514-50R—Tape Reel

Insertion Loss

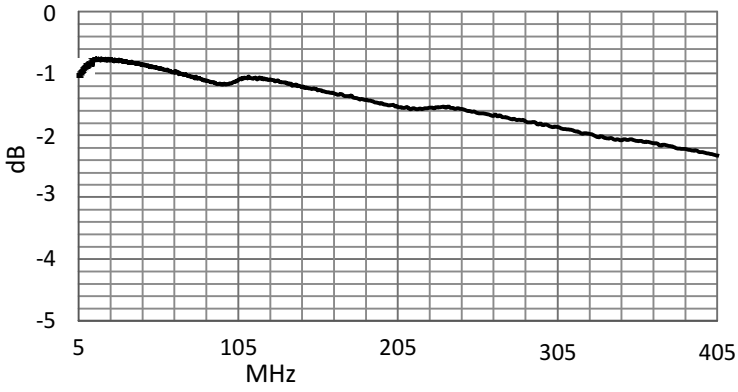

Input Return Loss

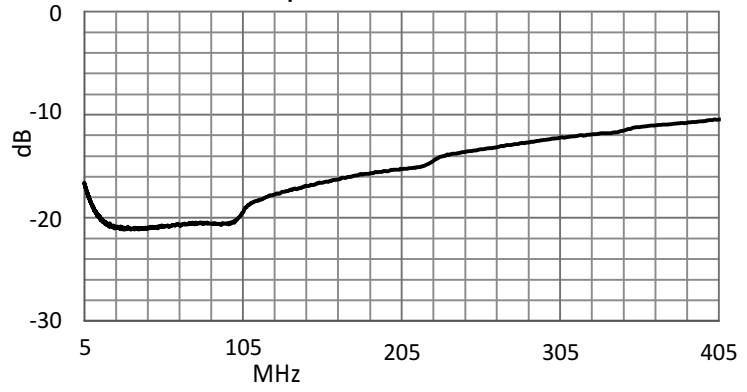

Amplitude Balance

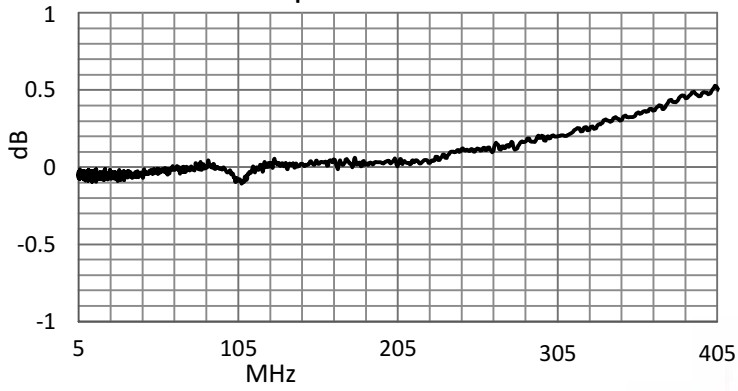

Phase Balance

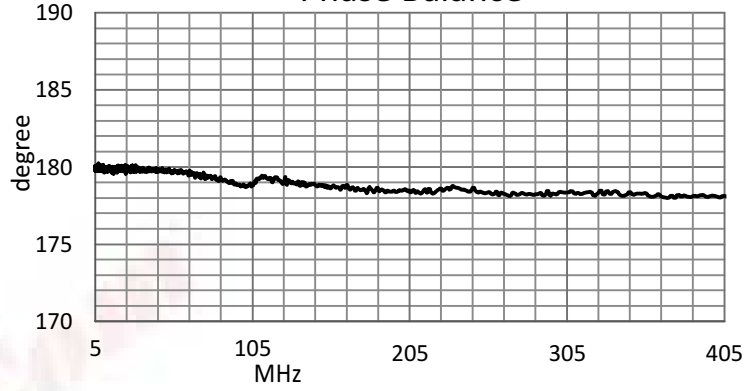

CMRR

