

Coupling Transformer

- RoHS Compliant
- Operating Temperature -40°C to +85°C

Electrical Specifications @25°C

Inductance	PIN 1-2= 25 uH Min. @ 100KHz/0.1V
Leakage Inductance	PIN 1-2= 135nH Max. @ 100KHz/0.1V (PIN 8,5 Shorted)
Interwinding Capacitance	PIN 1-8= 6 pF Max. @ 100KHz/0.1V
D.C.R.	PIN 1-2 = 55 mohm Max.
	PIN 8-5 = 35p mohm Max.
Turn Ratio	PIN 1-2 : PIN8-5 = 1.33±3% :1
HI-POT	PRI. – SEC. =5000VAC/60Hz/60Seconds/1mA

Dimensions

(Units: $\frac{\text{Inches}}{\text{mm}}$, Unless otherwise specified, all tolerances are $\pm\frac{.010}{.025}$)

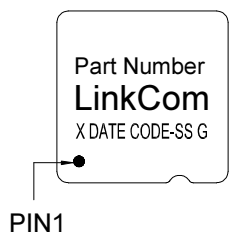

TOP VIEW

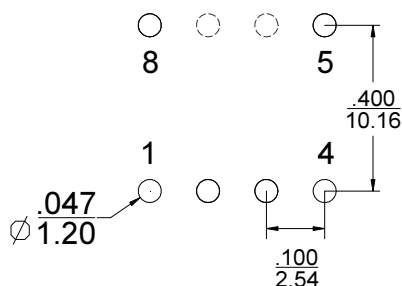

SUGGESTED PAD LAYOUT
Pin 6,7 cut off

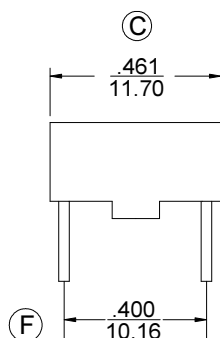
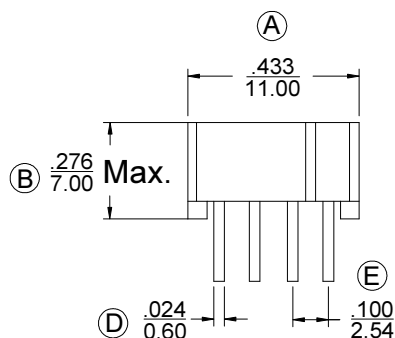

Schematic

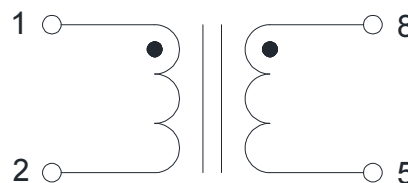

Mark

- 1.Part Number---LTC0585
2. X---PRODUCT LINE OR BLANK
3. DATE CODE---YYWW
- 4.SS---50 OR BLANK
5. G---RoHS

Package info

LTC0585-50P – Tray