

**Coupling Transformer**

- RoHS Compliant
- Operating Temperature -40°C to +85°C

**Electrical Specifications @25°C**

Inductance	PIN 1-4= 25uH Min. @ 10KHz/0.1V
Leakage Inductance	PIN 1-4= 300nH Max. @ 100KHz/0.1V (PIN 8,5 Shorted)
Interwinding Capacitance	PIN 1-8= 7 pF Max. @ 100KHz/0.1V
D.C.R.	PIN 1-4 = 140 mohm Max.
	PIN 8-5 = 215 mohm Max.
Turn Ratio	PIN 1-4 : PIN8-5 = 1.33±3% :1
HI-POT	PRI. – SEC. =1500VAC/60Hz/2Seconds/1mA

**Dimensions**

(Units:  $\frac{\text{Inches}}{\text{mm}}$  , Unless otherwise specified, all tolerances are  $\pm\frac{.010}{0.25}$  )

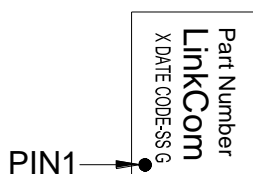

TOP VIEW

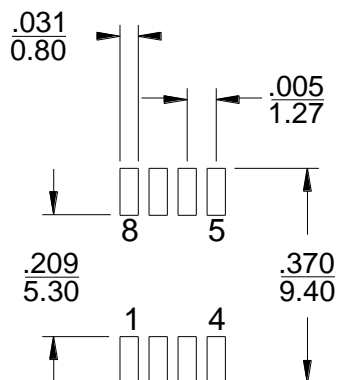

SUGGESTED PAD LAYOUT

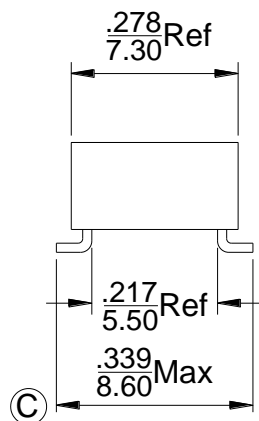
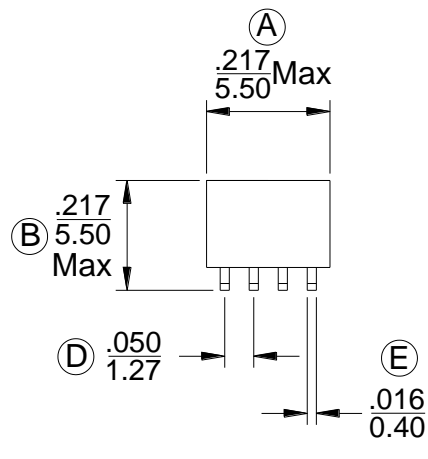

**Schematic**

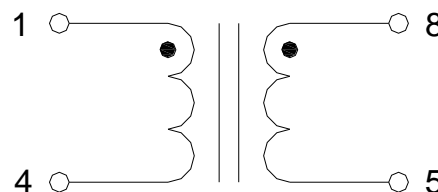

**Mark**

1. Part Number----LTC0626
2. X----PRODUCT LINE OR BLANK
3. DATE CODE----YYWW
4. SS----50 OR BLANK
5. G----RoHS

**Package info**

LTC0626-50R – Tape and Reel