

xDSL Transformer

- RoHS Compliant
- Operating Temperature -40°C to +85°C

Electrical Specifications @25°C

Inductance:	PIN 1-4 = 400uH ±7% @ 10KHz/0.1V/Series (PIN 2-3 Short)
Leakage Inductance:	PIN 1-4 = 850nH Ref. @ 1MHz/0.1V (PIN 2-3, PIN 7-8-9-10 Short)
Turn Ratio:	PIN 1-4 : PIN 10-7 = 2.0±2% : 1 (PIN2-3,PIN8-9 Short)
T.H.D	PIN 1-4 to PIN 10-7= -88dB Max. @ 30KHz/3V (PIN 2-3,PIN 8-9 Short)
D.C.R	PIN 1-4 = 1.50 ohm Max. (PIN2-3 short)
	PIN 10-7 = 1.25 ohm Max. (PIN8-9 short)
Hi-POT :	PRI. – SEC. =1875VAC/60Hz/1Second/0.5mA

Dimensions (Units: mm)

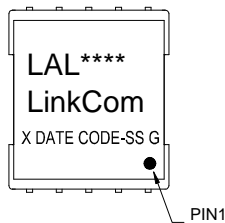

TOP VIEW

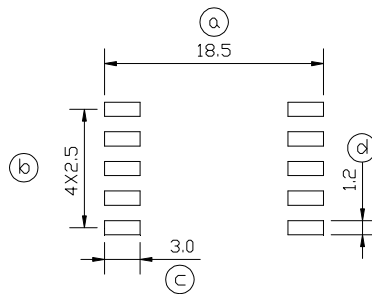

SUGGESTED PAD LAYOUT

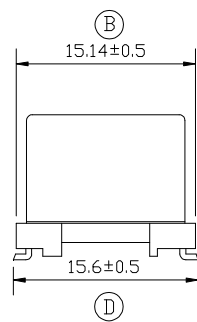
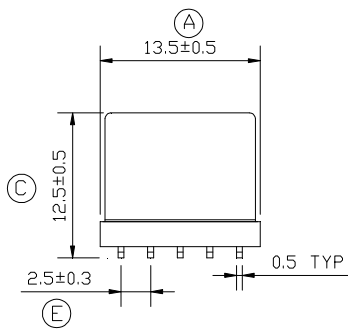

Schematic

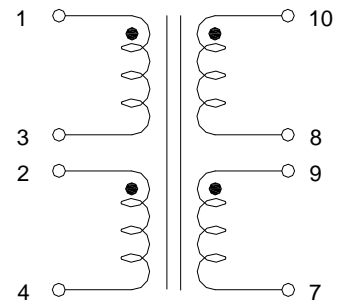

Mark

- 1.LAL****----LAL0562
2. X----PRODUCT LINE or BLANK
3. DATE CODE----YYWW
4. SS----50 OR BLANK
5. G----RoHS